

**OREGON PUBLIC LAND CORNER REPORT / RESTORATION REPORT**  
Tillamook County Surveyor's Office

**SECTION:** 31 and 6      **TOWNSHIP:** 1 South and 2 South      **RANGE:** 9 West

**COUNTY:** Tillamook      **DATE:** 02/2022

<b>CORNER DESIGNATION:</b> Quarter corner common to Section 31, Township 1 South and Section 6, Township 2 South, Range 9 West Willamette Meridian.	<b>(Please check one)</b>	
	<input type="checkbox"/>	Condition Report Only
	<input type="checkbox"/>	Restoration
	<input checked="" type="checkbox"/>	Rewitness
	<input type="checkbox"/>	Unrecorded
	<input type="checkbox"/>	Reset at surface
	<input type="checkbox"/>	Referenced Out

**Previous Rewitnesses, Restorations and Surveys, etc...**  
A-30 (?), A-152 (1933), A-159, A-299 (1947), A-318 (1948), A-744, A-1354 (1911), A-1446 (1967), A-1447 (1967), A-1633 (1968), A-1757 (1969), A-1868 (1969), A-1887 (1929), A-1939 (1970), A-1986 (1970), A-2040 (1970), A-2102 (1929), A-2864 (1975), A-3228 (1977), A-3885 (1977), A-5577 (1987), A-6051 (1990), A-7573 (2000), B-75 (1921), B-381 (1958), B-481 (1968), B-1216 (1986), B-2358 (2000), P-419 (1996), P-662 (2002), G.L.O. 1-2 South 9W pg. 48, S3 PG. 2 (1894), Rewitness bk. 10 pg. 116 (1894), AMA field book 14 pg. 88 (1897), S3 pg. 146 (1898), Rewitness bk. 4 pg. 60 (1949), Rewitness bk. 1 pg. 82 (1949), Rewitness bk. 2 pg. 411 (1960), Rewitness BK.6 pg. 45 (1965), Rewitness card #359 (1975), F-27-9 (1946), F-40-305, F-1-11, F-14-29, F-14-38, F-14-36, F-41-51

**History, condition, and sources:**  
In 1893 (G.L.O 1S 9W pg.48) Samuel Snowden set the ¼ section corner common to section 31, T.1S, R9W, and Section 6, T.2S, R.9W. From which he set 2 accessories. In 1894 (Rewitness Bk. 10 pg. 116) A. S. Burton found the corner and set one new accessory. IN 1949 (Rewitness bk. 4 pg. 60) W.E Anderson Sr. & Jr. set 2 new accessories to the corner. In 1960 (Rewitness bk. 2 pg. 411) Ken Tittle could find no evidence of the corner so he set 1 ½" Iron pipe for the ¼ corner off the 1 remaining bearing tree and added 1 new accessory. IN 1969 Alan E. Duncan added a 3" County Surveyors Brass Disk as shown hereon. In 1976 (Rewitness Card #359) the Tillamook County Surveyors office found the monument in good condition and added 2 new accessories. In 2020 The Tillamook County Surveyors Office Tied the monument directly with G.P.S. and found the monument as shown hereon.

- Found: (Rewitness card #359) 16" Maple S 61° W 27.0' healed face; Now 46"
- Not Found: (Rewitness card #359) 8" Spruce South 7.0'
- Found: (Rewitness card #359) 84" Hat Section post with Yellow metal location tag East 2.0'
- Found: Unknown origin Yellow metal bearing tree tag North 2.5'
- Found: (Rewitness card #359) 10" Tile and concrete around Tillamook County Brass Cap

**New accessories set:**  
Found: Top center of nut on fire hydrant N 34° W (hand compass) 44.65'  
The Monument was tied directly using G.P.S. established control. The coordinates have been converted and are provided here in WGS 84, Latitude and Longitude.  
Latitude: 45° 26' 02"  
Longitude: - 123° 50' 03"

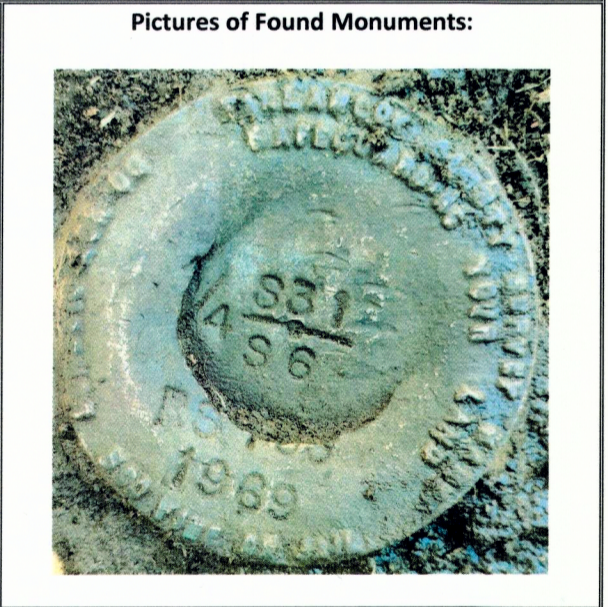

**Location:** Monument is located ±330' South on Fitzpatrick Rd. on the East side of the right of way in the corner of 2 intersecting fences.

**Tillamook County Surveyor office:** 1510 3<sup>rd</sup> Street Suite C, Tillamook, OR. 97141  
**Party Chief:** Terry Jones, P.L.S. 2507, Survey Supervisor  
**Witnesses:** Michael Rice, P.L.S. 86926, Tillamook County Surveyor  
Travis Porter, Survey Tech.  
**Notes:** Digital images taken of monument and accessories.

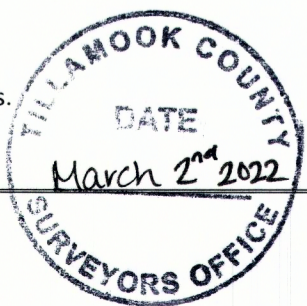

**SURVEYOR'S SEAL**

REGISTERED  
PROFESSIONAL  
LAND SURVEYOR

*Terry J. Jones*

OREGON  
JULY 25, 1991  
TERRY L. JONES  
2507

RENEWAL DATE: JUNE 30, 2023